



Catalogue
FOOD SERVICE
Chapter
DISTRIBUTION

Specific model
FCRE6-80-2 230V 1N 50/60Hz

19092141

20/05/2022

DENOMINATION:

Fresh product showcase well width 610 mm 2 GN 1/1 capacity FCRE6-80-2 230V 1N 50/60 Hz climate class 4 cold group included refrigerant gas R290

DESCRIPTION :

- Static refrigerated well with glass dome specially designed to hold the temperature and display fresh products (e.g. meat, fish, shellfish, etc.) so that these are selected by a guest and prepared by a chef in show-cooking stations.
- Well manufactured in stainless steel with satin finish.
- Well with rounded corners inside to make cleaning operations easier, ensuring maximum hygiene.
- Inclined stainless steel shelf to improve product visibility.
- Tempered glass dome to ensure maximum hygiene of displayed product.
- Static well refrigeration system by expanded copper coil located in its base.
- Polyurethane insulation with ecological injection, CFC-free, with high-density (40 kg/m³) allowing energy savings by reducing loss of cold air.
- Control panel with digital thermostat, protected by the structure perimeter, avoiding hindrances in their daily use.
- Control panel with 1-meter long cable, allowing to be installed on another element, e.g. furniture under the drop-in element.
- Electronic thermostat, with digital display, to control and regulate the temperature on the showcase well at the desired set point.
- Automatic defrost system that minimizes compressor workload and saves energy.
- Stamped drain on the well, to discharge condensation water. A connection from the drain to the sanitation network is compulsory.
- Robust structure with 13 mm thick overlap, once element is dropped-in on the worktop, ensuring cleanness and aesthetics.
- Operating temperature on the base of the refrigerated showcase well: from -10 °C to +5 °C.
- Two separate compartments to hold and display different types of products (e.g. meat, fish) avoiding cross contamination and ensuring compliance with food standards.

POSSIBLE ACCESSORIES :

- TOOL TO LIFT DROP-IN

DIMENSIONS



X Width	812 mm	X Gross width	820 mm
Y Depth	621 mm	Y Gross depth	895 mm
Z Height	819 mm	Z Gross height	680 mm
Net Weight	69,0 kg	Gross Weight	74,0 kg
Net volume	0,413 m ³	Gross volume	0,499 m ³

ELECTRICITY TECHNICAL SPECIFICATIONS

Electric power	0,245 kW
Amperage (A)	1,36A
Voltage	230V - 1N
Electric frequency	50/60Hz

GAS TECHNICAL SPECIFICATIONS

Gas type	R-290
----------	-------

COLD TECHNICAL SPECIFICATIONS

Refrigeration power	0,175 kW
Climate class	4
Cooling gas load	86,000 g

CONNECTIONS TECHNICAL SPECIFICATIONS

Drain 1 diameter	1/2"
------------------	------

SERVICE TROLLEY ACCESSORIES

Cut-out Length (mm)	765
Cut-out Width (mm)	585
Capacity (GN)	2 x GN1/1
Plate type	Static refrigerated



Catalogue
FOOD SERVICE
Chapter
DISTRIBUTION

Specific model
FCRE6-80-2 230V 1N 50/60Hz

19092141

20/05/2022

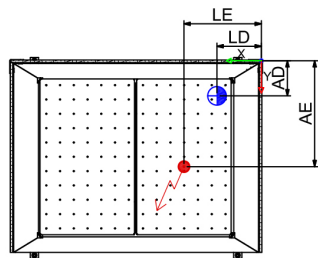
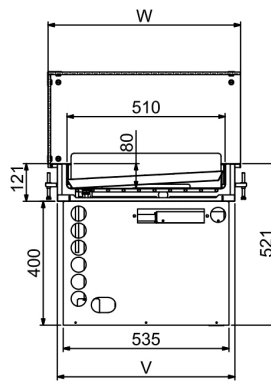
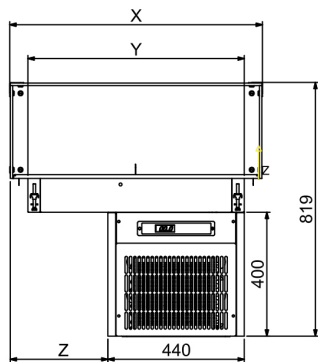

H⊕ : - 110 mm

H⊙ : - 162 mm

W = 610 mm	W = 720 mm
LE : 207 mm	LE : 207 mm
LD : 143 mm	LD : 143 mm
AE : 335 mm	AE : 390 mm
AD : 113 mm	AD : 168 mm

	X	Y	Z	W = 610 mm V	W = 720 mm V
1GN	487	440	120	573	683
2GN	812	765	315	573	683